

TECHNICAL BULLETIN

Installing CanExel® Prefinished Exterior Trim in Canada

A SUPPLEMENTAL GUIDE TO THE STANDARD MIRATEC® APPLICATION INSTRUCTIONS

CanExel® prefinished exterior trim on MiraTEC® substrate was conceived and engineered to resist moisture, rot and termites, so it is perfect for exterior non-structural applications. It handles like wood and complies with Canadian building codes (CCMC 14015-L from the Canadian Construction Materials Centre).

WE MAKE EVERY EFFORT TO ENSURE THAT MIRATEC TRIM MEETS OUR QUALITY STANDARDS. IT IS IMPORTANT TO READ ALL THE FOLLOWING INSTALLATION AND MAINTENANCE INSTRUCTIONS PRIOR TO INSTALLATION. PLEASE NOTE: FAILURE TO COMPLY WITH THE FOLLOWING INSTALLATION AND MAINTENANCE INSTRUCTIONS WILL IMPACT THE FULL BENEFIT OF THE LIMITED PRODUCT WARRANTIES (AVAILABLE AT MAIBEC.COM). FOR SPECIFIC QUESTIONS RELATED TO THESE INSTALLATIONS, PLEASE EMAIL INFO@MAIBEC.COM.

Read this entire guide before installing your trim. For proper installation, you must understand and follow all requirements and steps correctly. **DOWNLOAD THE LATEST VERSION ONLINE AT MAIBEC.COM.** For any questions, please contact Maibec's technical service toll-free at 1-800-363-1930, Monday to Friday from 8:30 a.m. to 4:30 p.m. (Eastern Time).

Drawings in this document are not to scale and are used solely to illustrate best practices.



2. STORAGE

- Keep the trim in a dry, unheated and well-ventilated area.
- Cover any unused trim with its original packaging at all times, even during installation. If the original packaging is no longer in good condition, cover the trim with a waterproof tarp.
- The trims must be kept on Maibec CanExel™ supplied packing material and must remain flat. Never let it come into direct contact with the ground.
- Keep trim clean and dry at all times. Inspect prior to application.
- Allow trim to adjust to atmospheric conditions before application.
- Touch-up paint must always be kept at room temperature (minimum 15°C/60°F).

FIGURE 1

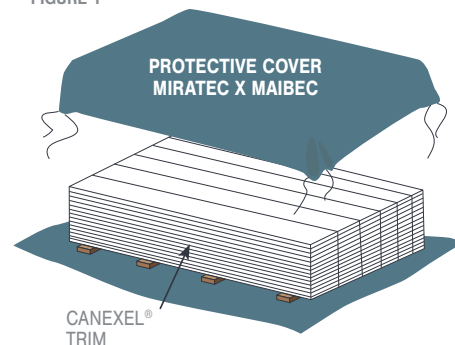

1. BEFORE YOU BEGIN INSTALLATION

1.1 CHECK YOUR ORDER

- Make sure the product(s) delivered matches your order (colour, profile, quantity, nails, accessories, etc.).
- Have on touch-up paint on hand.
- Never install a product that appears to be or that you think may be defective. Installed defective products are not covered by the warranty. Contact Maibec at 1 800 363-1930.

1.2 CONSULT THE BUILDING CODES

Make sure you are familiar with the specific requirements of all applicable federal and provincial building codes and municipal by-laws for your region with respect to installing trim, water-resistive barrier, sealant, etc. For the water-resistive barrier and the sealant, follow the manufacturers' instructions.

For more information, see the National Model Construction Codes on the Government of Canada's website at nrc.canada.ca.

3. CUTTING

- Use a fine-tooth hand saw or power saw with a combination blade.
- Cut into the exposed face of the material.
- Carbide-tipped blades are recommended.

4. FASTENING REQUIREMENTS AND BUTT JOINT

CanExel® prefinished exterior trim is a non-structural decorative trim product and should not be used where structural lumber properties are required. CanExel® prefinished exterior trim is designed to be applied to structural framing, sheathing and other materials.

NOTE: Nail at least 12,7 mm (1/2") from the edge. Do not nail into the edges of trim. For 19 mm (3/4") (4/4) and 25,4 mm (1") (5/4) fascia and soffit applications, CanExel® prefinished exterior trim can be fastened directly to the rafter ends, double nailed a maximum of 0,61 m (24") on center. [FIGURE 5]

For 15,8 mm (5/8") fascia and soffit applications, CanExel® prefinished exterior trim must have a sub-fascia and be nailed 0,4 m (16") on center to the rafter ends or sub-fascia. For all other horizontal and vertical applications, double nail 0,4 m (16") on center, falling on the studs. Always comply with local building code for clearance between trims and flashings or other components.

ALL JOINTS MUST BE IN CONTACT WITH EITHER FURRING STRIP, OSB PANELS, PLYWOOD OR STUD.

- Use sealant on all field cuts and exposed ends in joints.
- For runs less than 9 m (30 feet) in length, butt joints should lightly touch. Please refer to the sealant manufacturer's instructions for application.
- For runs over 9 m (30 feet) in length, space all butt and scarf joints 3 mm (1/8") apart and apply sealant into the full depth of the 3 mm (1/8") joint.
- Double nail all joints on both sides as noted in the diagram. [FIGURE 6]
- Corners made of 2 trims cut at 45° are prohibited. [FIGURE 7]
- Trim should be installed **BEFORE** siding.

FIGURE 2

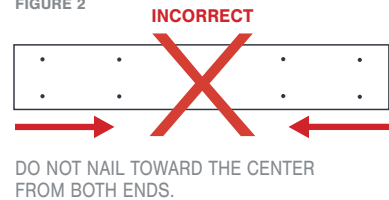

FIGURE 3

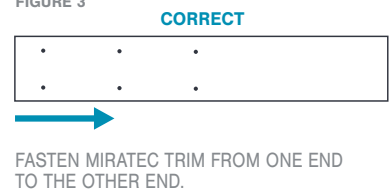

FIGURE 4

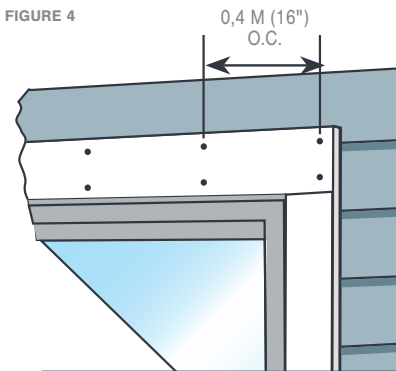

FIGURE 5

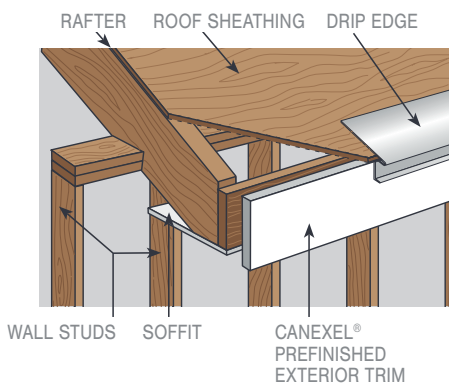

FIGURE 6

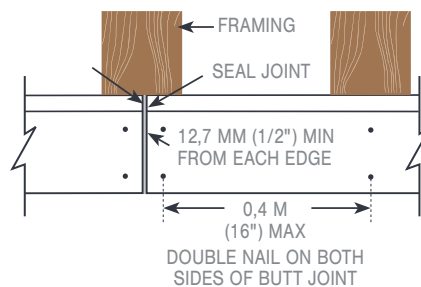
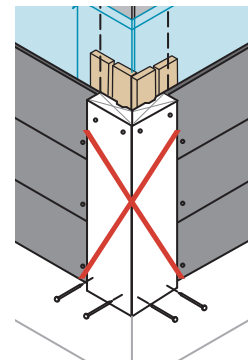

FIGURE 7



5. FASTENERS

CanExel® prefinished exterior trim is installed with Maibec textured flat-head corrosion resistant nails with textured head as described below.

DO NOT USE STAPLES!

5.1 NAIL SPECIFICATIONS

The nails specified below ensure the required minimum real penetration of 32 mm (1 1/4") into solid wood or equivalent.

8d hot dipped galvanized steel with:

- A 2,5 mm (0,099") shank minimum
- A 6 mm (0,24") head diameter minimum
- Starting at 9,5 mm (3/8") from the head

If you are using exterior insulation, whether rigid or non-nailable, refer to the Maibec CanExel™ siding technical bulletin for the complete installation steps.

If Maibec CanExel™ siding is installed in Coastal regions,* stainless steel grade 316 ringed nails must be used for installing siding and trims. These nails must have the same shank, head, length and ring pattern as the galvanized-steel ring shank nails described above. Failure to comply with this requirement will void the warranties.

* APPLICABLE COASTAL REGIONS INCLUDE THOSE LOCATED LESS THAN 600 M (2,000 FT) FROM THE COASTLINE IN THE ATLANTIC PROVINCES (NEW BRUNSWICK, PRINCE EDWARD ISLAND, NOVA SCOTIA, NEWFOUNDLAND AND LABRADOR), AND IN SAINT-PIERRE-ET-MIQUELON.



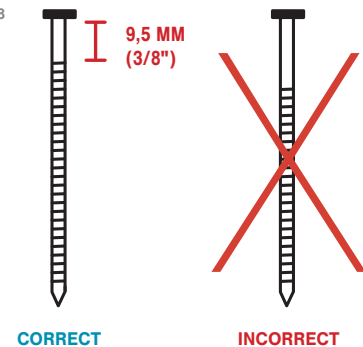
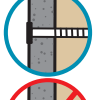
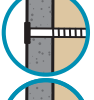

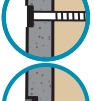

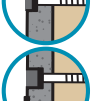

FIGURE 8



5.2 NAILING

- Maintain a minimum penetration of 32 mm (1 1/4") in solid wood (wood, plywood or OSB). The nails must also meet the structure.
- Nailable sheathing may be included in the penetration requirement.
- Increase nail penetration if code requires.
- All exposed face nails must be properly sealed in a manner that prevents moisture intrusion and water buildup. [FIGURE 9]

FIGURE 9

CONDITION	»	CORRECTION : INVISIBLE NAILS	VISIBLE NAILS
 SNUG	»	 OK	PAINT
 FLUSH	»	 OK	PAINT
 VISIBLE FIBER	»	 PAINT	PAINT
 COUNTERSUNK 1,6 TO 3 MM (1/16" TO 1/8")	»	 SEAL WITH CAULKING	APPLY SEALANT AND PAINT
 COUNTERSUNK MORE THAN 3 MM (1/8")	»	 SEAL WITH CAULKING AND RENAIL	APPLY SEALANT AND PAINT. RE-NAIL

6. SEALANT

Sealant is required at all joints and where CanExel® prefinished exterior trim abuts siding, windows, doors, other materials, or other MiraTEC product. We recommend sealants that meet ASTM C920. The purchaser, general contractor, installer, and others who are using or installing this product are responsible for ensuring that a proper caulk joint is installed that is compliant with the local building code, industry standards and to ensure that it coats the full depth of any joints.

- Use only exterior quality sealant that remains flexible over time.
- Do not use hard-setting caulk, Bondo® or similar hard setting fillers or putties on trim. They will crack over time due to the natural expansion and contraction of the trim.
- Apply caulk and sealant according to the manufacturer's written instructions.

For a full listing of recommended sealants visit miratecextira.com.



7. FLASHING AND MOISTURE CONTROL

The structure on which trim is applied should be well ventilated and dry. Do not apply CanExel® prefinished exterior trim over wet sheathing, or any closer than 0,2 m (8") to finished grade such as flower beds, mulch, or final landscaping per local building codes.

CanExel® prefinished exterior trim is not a structural product and is not designed to hold the weight of gutters. Fasteners to hold the gutters in place can pass through trim, but must be anchored into structural framing members for structural support.

7. Flashing and moisture control (cont'd)

WINDOWS

Maintain a min 6,35 mm (1/4") gap and fill with caulk, or backer rod and caulk, where the trim is applied next to windows. If the window installation instructions call out a different gap, then default to their published instructions.

FIGURE 10

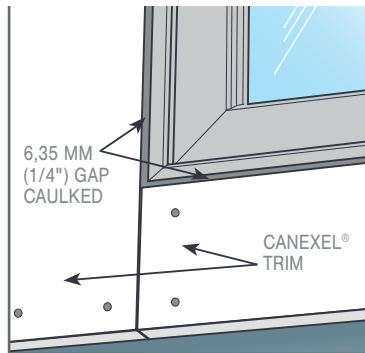

J-CHANNEL

Maintain a min 6,35 mm (1/4") gap and fill with caulk where the trim butts against J-Channel. This applies for both vertical and horizontal applications of trim and J-Channel. J-Channel is not a substitute for flashing.

FIGURE 11

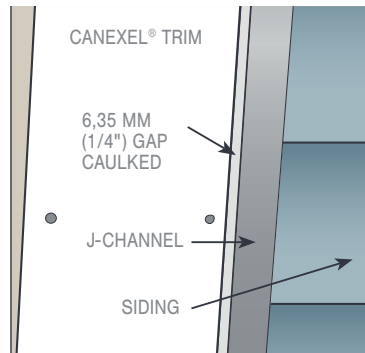

NEAR ROOF LINES

FIGURE 12

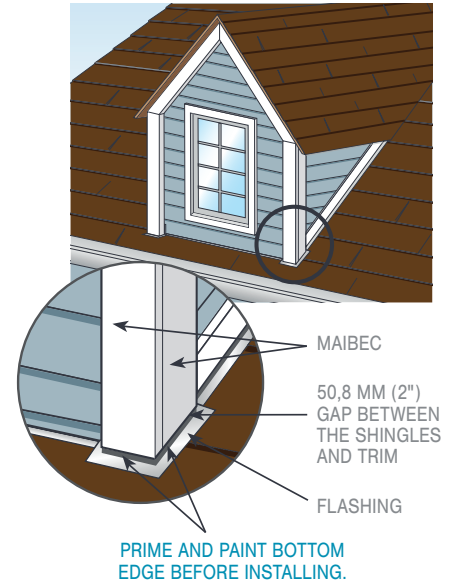

8. WINDOW & DOOR FINISHING DETAILS

8.1 ABOVE WINDOWS

Flashings over openings must:

- Have a slope outward at an angle of at least 6%.
- Minimum 1/2" spacing between flashing and the siding to allow for adequate drainage and air flow.
- Cover the building element below it vertically by at least 12,7 mm (1/2")
- Projection of at least 6,35 mm (1/4") beyond the outer face of the building element below it.

WITH WOOD FINISHING MOULDINGS
(in Quebec only)

FIGURE 13

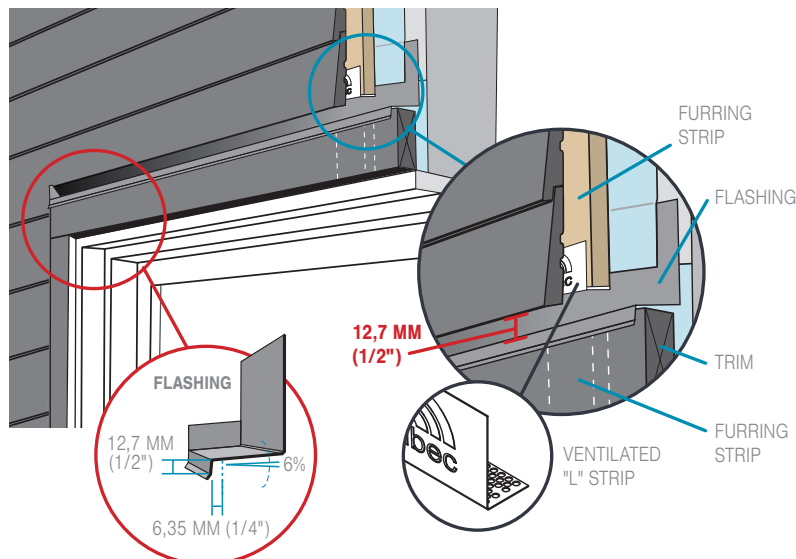

WITH WOOD FINISHING MOULDINGS
(Elsewhere in Canada)

FIGURE 14

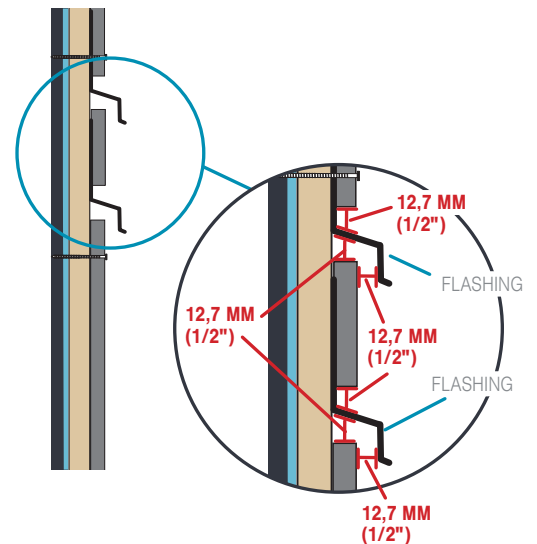

8. Window & door finishing details (cont'd)

8.2 BELOW WINDOWS

All flat horizontal surfaces (such as window sills) are prone to water or snow accumulation. To avoid such accumulation, one of the following options is mandatory:

- flashing with a minimum 6% slope
- sealant [FIGURE 17]

To minimize movements in the boards, ventilation at the bottom of windows is required when the window has a width of more than 1,22 m (4 ft) and is located more than 1,22 m (4 ft) from the first course.

WITH WOOD FINISHING MOULDINGS

FIGURE 17

CORRECT

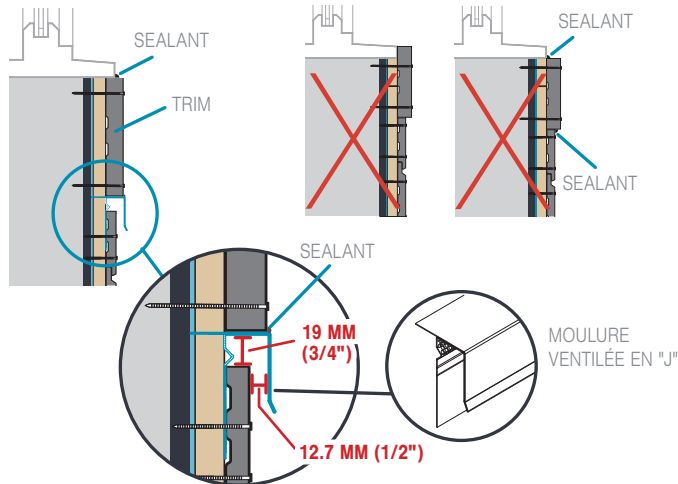
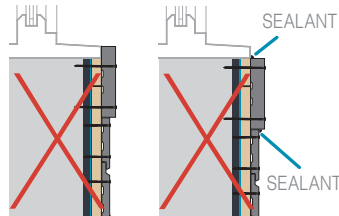

FIGURE 18

INCORRECT



WITHOUT FINISHING MOULDINGS

FIGURE 16

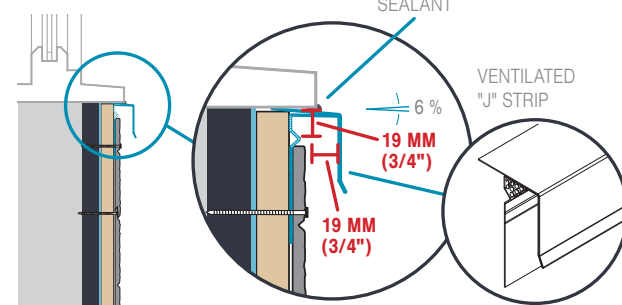

8.3 TOP OF WALLS

WITH WOOD FINISHING TRIMS - VENTILATED \"L\" STRIP OR VENTILATED BAND*

FIGURE 19

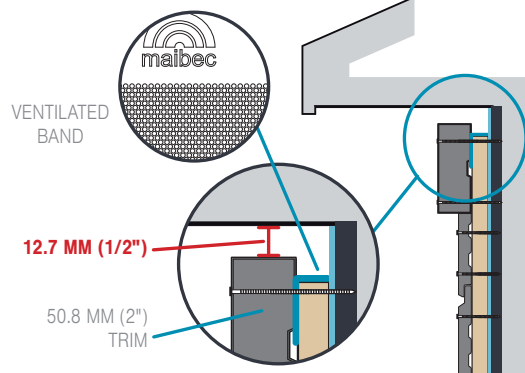

*WHEN ROOF OVERHANG EXCEEDS 50.8 MM (2")

9. PAINT APPLICATION

- **Paint all raw and field cut ends of trim** which will be exposed to the weather. Use a high quality exterior primer and paint formulated for use on composite wood.
- Coat all exposed surfaces including the bottom edge.
- Touch up all exposed nails.
- Use a polyester, nylon or synthetic applicator with firm bristles approved for water-based coatings.

NOTE: Always touch up boards **BEFORE** installing them.



NEVER APPLY TOUCH-UP PAINT OVER UNDAMAGED OR NON-EXPOSED FACTORY-COATED MATERIAL.



10. NON-RECOMMENDED APPLICATIONS

CanExel® prefinished exterior trim is not recommended for applications that will encourage standing water, extended moisture contact or those providing structural support. Examples of such uses include, but are not limited to:

- Siding
- Railing
- Fencing
- Trellis
- Pergolas
- Deck boards
- Planter Boxes
- Stairway components (treads, risers, stringers, etc)

For further product information, please call 1 800 363-1930 or write to:
Maibec CanExel™, 202 - 1984, 5^e Rue, Lévis, Québec G6W 5M6, Canada.